

**MATERIAL**

Stainless steel, matte finish.  
AISI 304 stainless steel screw and nut.

**FEATURES AND APPLICATIONS**

The assembly hole of GN 162.3-NI connecting clamps allows an excellent match with tubes GN 990 (see page 1954).  
The clamping screws d3 may be replaced by clamping kits GN 911 (see page 1958).

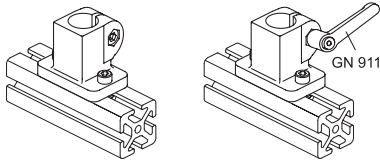

Conversion Table	
1 mm = 0.039 inch	
d1	
mm	inch
12	0.46
14	0.55
15	0.59
16	0.63
18	0.71

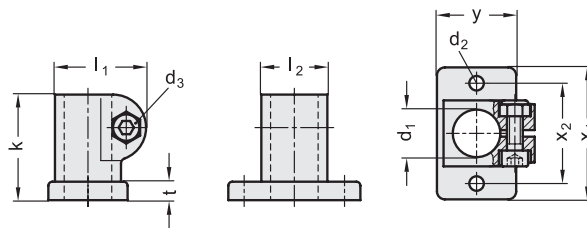

Code	Description	d1	d2	d3	k	l1	l2	t	x1	x2	y	d3 Clamping kit	⚖️
GN.48319	GN 162.3-B12-2-NI	12	5.5	M6	40	34.5	25	7	50	38	30	GN 911-M6-22	92
GN.48329	GN 162.3-B14-2-NI	14	5.5	M6	40	34.5	25	7	50	38	30	GN 911-M6-22	88
GN.48336	GN 162.3-B15-2-NI	15	5.5	M6	40	34.5	25	7	50	38	30	GN 911-M6-22	86
GN.48349	GN 162.3-B16-2-NI	16	5.5	M6	40	34.5	25	7	50	38	30	GN 911-M6-22	84
GN.48359	GN 162.3-B18-2-NI	18	5.5	M6	40	34.5	25	7	50	38	30	GN 911-M6-22	79